



**RE/MAX**  
North



5 McCreedy Drive, Salford, M5 3JJ

Asking price £260,000







# 5 Mccready Drive

Salford, M5 3JJ

- Spacious Garden
- Easy access to motorway
- Easy access to Metrolink
- Nearby sought after Media City / Salford Quays locations

Nestled on McCready Drive in the vibrant area of Salford, this charming end-terraced house offers a delightful blend of comfort and modern living. Spanning approximately 850 square feet, the property features two well-proportioned bedrooms, making it an ideal choice for small families or professionals seeking a cosy yet spacious home.

Upon entering, you are welcomed into a bright reception room that exudes warmth and style, perfect for both relaxation and entertaining. The modern furnishings throughout the home enhance its appeal, creating an inviting atmosphere. The property also boasts a well-appointed bathroom, ensuring convenience for all residents.

One of the standout features of this home is the very large garden, which provides an excellent outdoor space. The gated driveway offers secure parking for one or two vehicles, adding to the practicality of this lovely residence.

This property combines contemporary living with the charm of a well-established neighbourhood. Additionally, the ample storage options throughout the house cater to all your organisational needs, making it easy to keep your living space tidy and clutter-free.





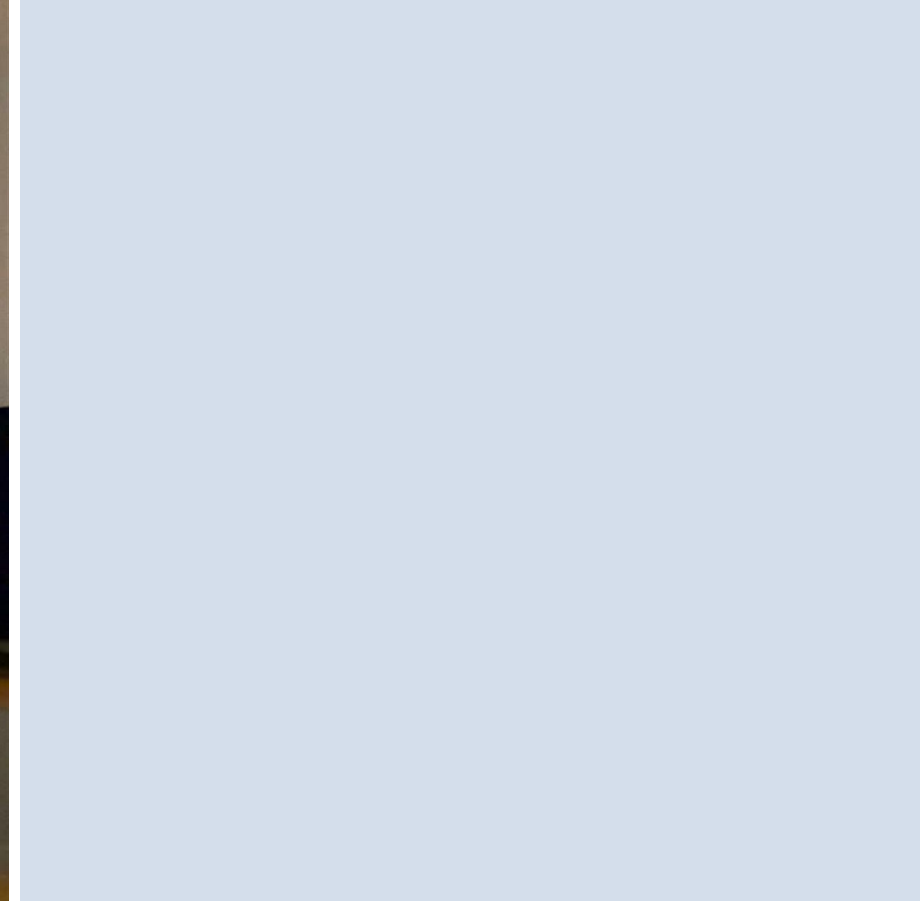





## Floor Plans

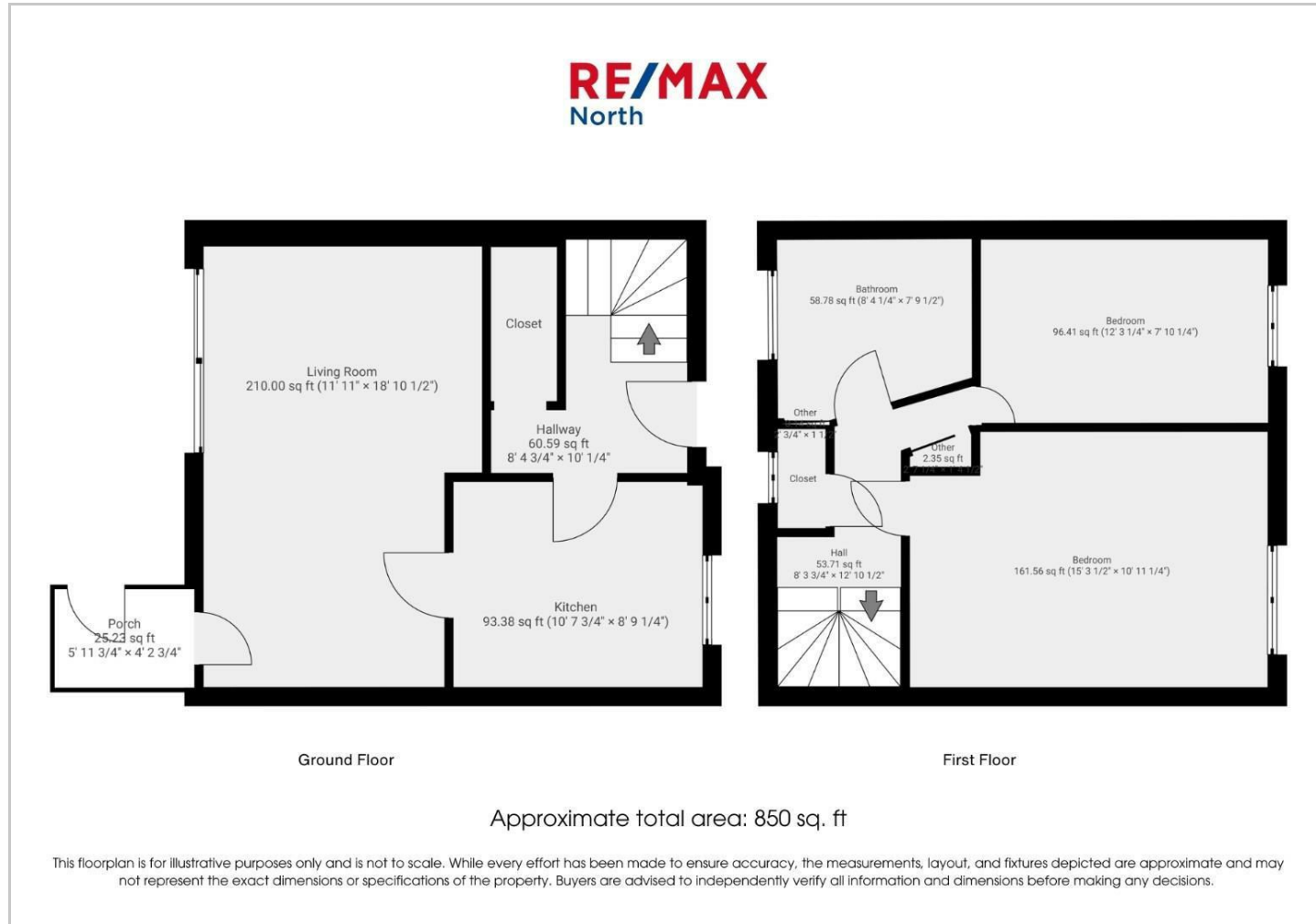

## Viewing

Please contact our RE/MAX North Sales Office on +44 (0) 1618 040807 if you wish to arrange a viewing appointment for this property or require further information.

The particulars are set out as a general outline only for the guidance of intended purchasers or lessees, and do not constitute, any part of a contract. Nothing in these particulars shall be deemed to be a statement that the property is in good structural condition or otherwise nor that any of the services, appliances, equipment or facilities are in good working order. Purchasers should satisfy themselves of this prior to purchasing.

## Location Map

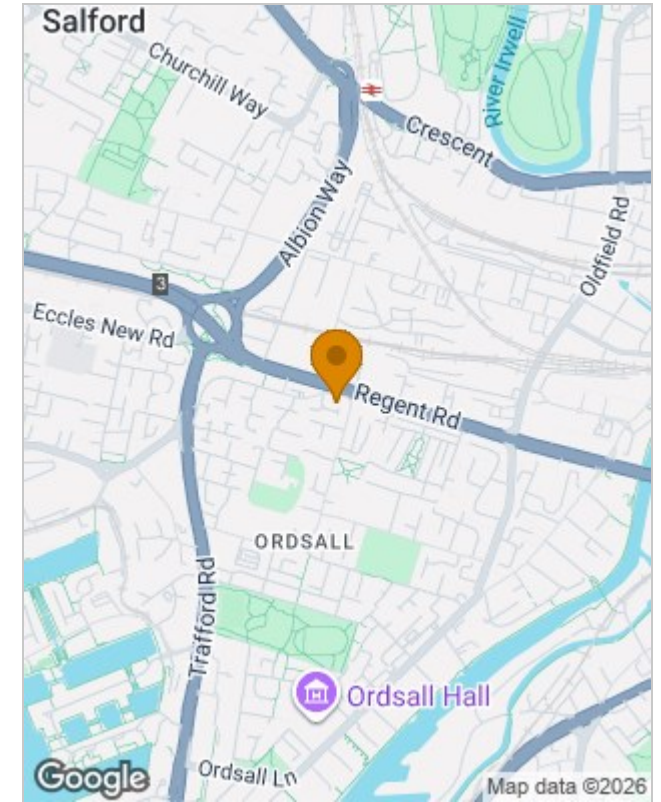

### Energy Performance Graph

